

AGM 2009 program

All events occur in the Scotia Bank Conference Theatre (Sobey Building)
unless otherwise indicated

Wednesday, December 9th, 2009

18:00 GCN Board of Directors meeting (closed)
Westin Nova Scotian: Maritime Room

Thursday, December 10th, 2009

8-9:00 **Registration & Refreshments**
Location: Private Dining Room
Posters set-up

9:00 **Opening Remarks** Dr. Terry Murphy, VP Academic, Saint Mary's University
Dr. Malcolm Butler, Dean of Science, Saint Mary's University

9:15 – 10:30 **Panel A: *Plant CO₂ responses*** (GCN Theme 3)
Chair: Chantal Hamel. AAFC

9:15 Identification and characterization of plant variants exhibiting enhanced photosynthesis and biomass production under elevated CO₂, high temperature and drought.
Bernard Grodzinski, University of Guelph, Project 3a

9:40 Reverse engineering plant variants for direct C sink management: respiratory metabolism of natural plant variants with beneficial growth responses to prolonged elevated CO₂ levels.
Norman Huner, University of Western Ontario Project 3b

10:05 Nitrogen acquisition and biomass production
Norman Huner, University of Western Ontario, Project 3d

10:30-11:30 **Green Crop Network Graduate Student mini-symposium**

10:30 Effect of cold acclimation, heat stress and CO₂ on the accumulation of COR proteins and mRNA of photosynthetic genes in wheat.
Khalil Kane, Keshav Dahal, Norman Huner and Fathey Sarhan

10:45 Yuanyuan Liu Regulation of secondary cell wall biosynthesis in Arabidopsis by KNAT7 transcription factor complex
Yuanyuan Liu, Eryang Li, Shucui Wang, Jin-Gui Chen, Carl J Douglas

11:00 The LEAFY COTYLEDON1 Gene is a Potential Candidate for Improving the Seed Oil Content of Canola
J. Prystenski, C. Stasolla and M. Tahir

11:15-12:00 **Coffee Break (Poster Session A)**
Location: Private Dining Room
Green Crop Network Graduate Student mini-symposium continued

12:00 Characterization of glomalin related soil protein fraction: XANES, Py-FIMS and proteomics.
Gillespie, Adam W., Farrell, R.E., Walley, F.L. and Ross, A.R.S

12:15 Isolation and implementation of switchgrass endophytes into low-input switchgrass agroecosystems
Keomany Ker, James W. Fyles, Brian T. Driscoll, Philippe Seguin and Donald L. Smith

- 12:30 Response of N₂O to N Management and Breeding for Seed Oil in Biodiesel Dedicated Canola
Labib El-Ali, David Burton, Kevin Vessey, Derrick Lynch
- 12 45-14:00 **Lunch (Dockside Dining Hall)**
Joint meeting of the GCN Scientific Advisory Committee & Board
Location: Secunda Marine Boardroom
- 14:00-15:14 **Panel B: Biofuel Crops** (GCN Theme 4)
Chair: Donald Smith, McGill University
- 14: 00 The bilateral influence of plant and rhizosphere characteristics in *Brassica* sp. varying in seed oil productivity.
Kevin Vessey, Saint Mary's University, Project 4c
- 14:25 Investigation of the contribution of oil biosynthetic enzymes to seed oil content in *B. napus* and *A. thaliana*.
George Haughn, University of British Columbia, Project 4b
- 14: 50 Identification of *Brassica* genotypes and molecular markers for increased seed-oil content.
Peter McVetty, University of Manitoba, Project 4a
- 15:15-16:00 **Poster Session B (refreshments)**
Location: Private Dining Room

17:30 - 22:30	<p>Green Crop Network Banquet Pier 21 Canada's Immigration Museum 1055 Marginal Road, Halifax</p> <p>17:30-18:30 small reception 18:30 Banquet</p>
---------------	---

Friday, December 11th, 2008

- 8:00-9:00 **Refreshments**
Location: Private Dining Room
- 9:00 **Word from the GCN**
- 9:10-10:25 **Panel C: Soil Carbon Stocks** (GCN Theme 2)
Chair: Henry Janzen, AAFC
- 9:10 Transforming plant C into soil C: process-level controls on C sequestration.
Sandra Yanni will present on behalf of Joanne K. Whalen, McGill University, Project 2d
- 9:35 Microbial control of plant responses to climate change related stresses.
Don Smith, McGill University, Project 2c
- 10:00 Manipulating lignin deposition.
Carl Douglas, University of British Columbia, Project 2a
- 10:25-10:45 **Coffee break**
Location: Private Dining Room
- 10:45-11:05 Can utilization nitrogen use efficiency in rice be improved by overexpressing cytosolic glutamine synthetase?
Rochon, A., Brauer, E.K, Rothstein, S., Shelp, B.J.
- 11: 05-11:25 The promotion of N₂O emission by H₂ released from soybean symbiosis in a field experiment
Yan-Ping Cen, Neal A. Scott, Malcolm, J. Morrison, Edward G. Gregorich and Dave B. Layzell
- 11: 25-12: 25 **GCN Climate Change Course** Project Leader meeting (closed)
(Adobe Connect Workshop) Location: Unilever 4th Floor Lounge, Sobey Building
- 12: 25-13:25 Lunch (Dockside Dining Hall)
- 13: 25-15:05 **Panel D: Nitrous Oxide (N₂O) Emissions** (GCN Theme 1)
Chair: Jim Germida, University of Saskatchewan
- 13:25 Nitrogen fixation, hydrogen production and N₂O emissions.
Zhongmin Dong, Queen's University, Project 1f
- 13:50 Nitrous oxide emission from the rhizosphere: microbial coordination of sources and mitigation.
Steven Siciliano, University of Saskatchewan, Project 1d
- 14:15 Manipulation of rhizosphere organisms to enhance C-sequestration and reduce N₂O emissions.
Rich Farrell, University of Saskatchewan, Project 1c
- 14:40 Identification of regulatory genes to reduce N₂O production.
Illimar Altosaar, University of Ottawa, Project 1b
- 15:05 Identification of regulatory genes to improve nitrogen use efficiency.
Steven J. Rothstein, University of Guelph, Project 1a
- 15:25-15:35 **Closing statements GCN Scientific Director**
- 15:45 **GCN Scientific Advisory meeting (closed)**
Location Sobey Building 415

Saint Mary's University
923 Robie Street Halifax, Nova Scotia

Scotia Bank Conference Theatre (2nd floor Sobeys Building)

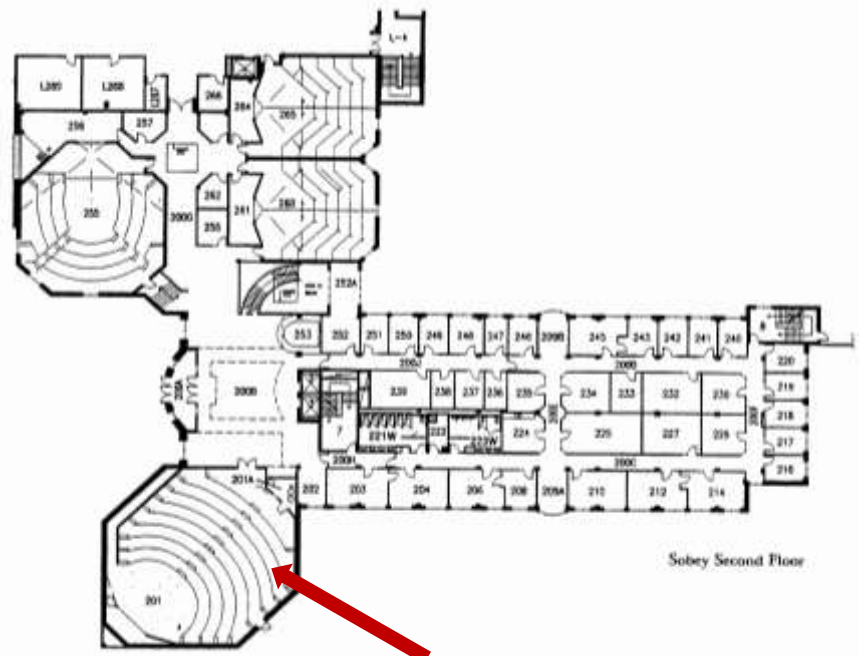
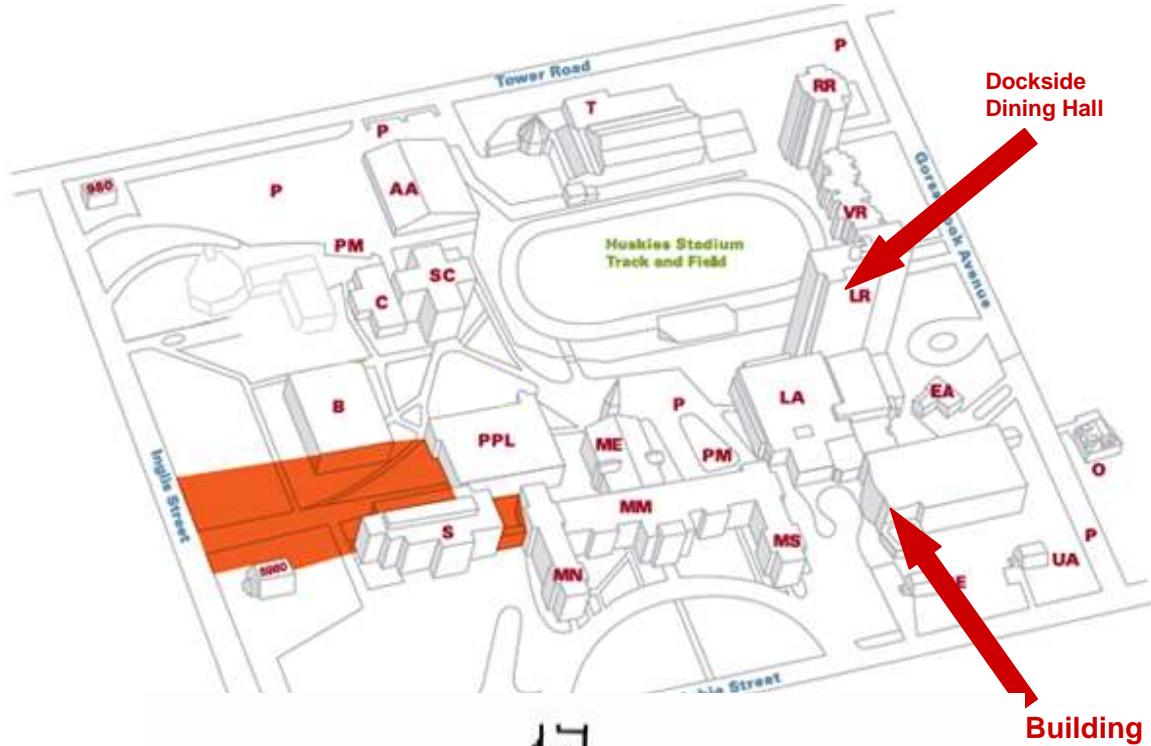

Scotiabank Conference

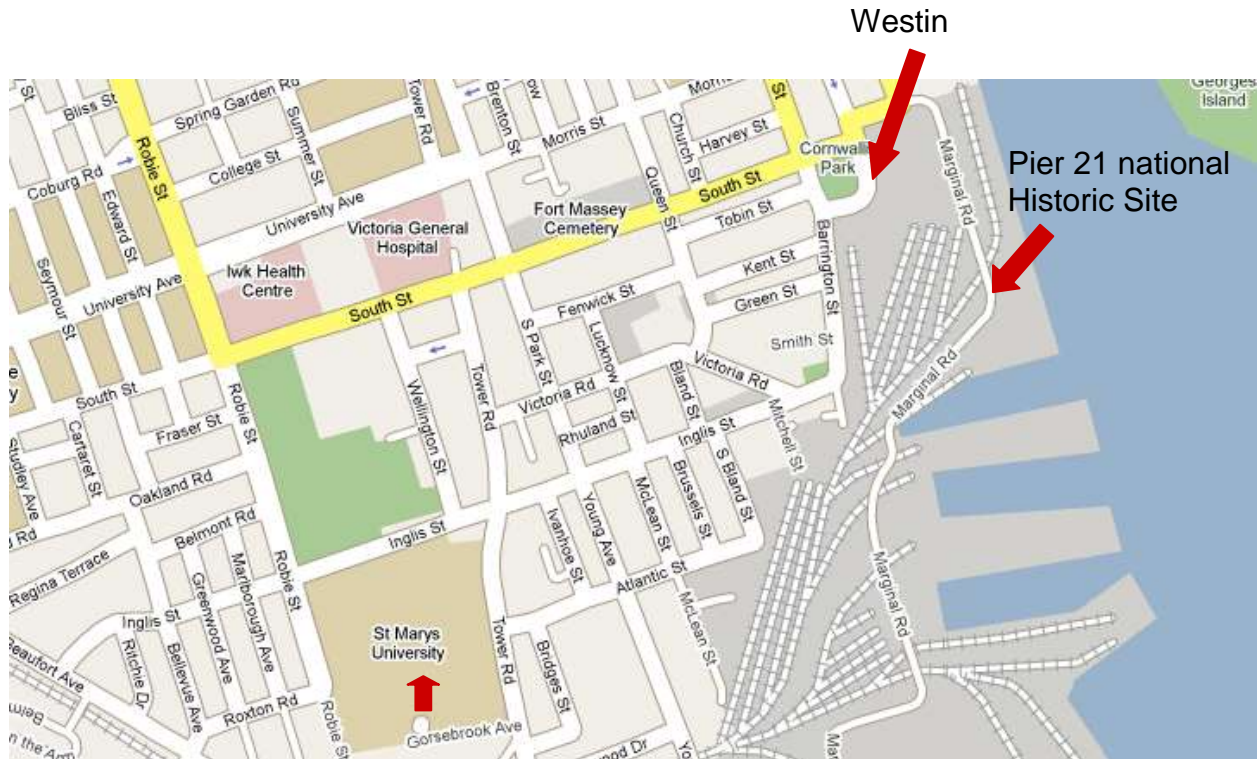

**St. Mary's
University**

Saint Mary's University:
923 Robie Street Halifax, Nova Scotia

Pier 21 Canada's immigration Museum:
1055 Marginal Road, Halifax, Nova Scotia B3H 4P6

Westin Nova Scotian:
181 Hollis Street, Halifax, NS B3H 2P6
(902) 421-1000 1-888-679-3784

Directions by public transport:

From Westin Nova Scotian:

Walk to Barrington St [southbound] before South St.; Take Bus **9** - Barrington - Direction: 9 Barrington; Arrive Inglis St [westbound] before Tower Rd (Stop ID: 6970)

From SMU to Pier 21

Walk to Inglis St after Robie St; Take bus **14** - Leblin Park - Direction: 14 Downtown. Arrive Arrive spring Garden Rd [eastbound] in front of Barrington St); Walk to 1055 Marginal Road (about at 15min walk)